

परमेश्वर - 1

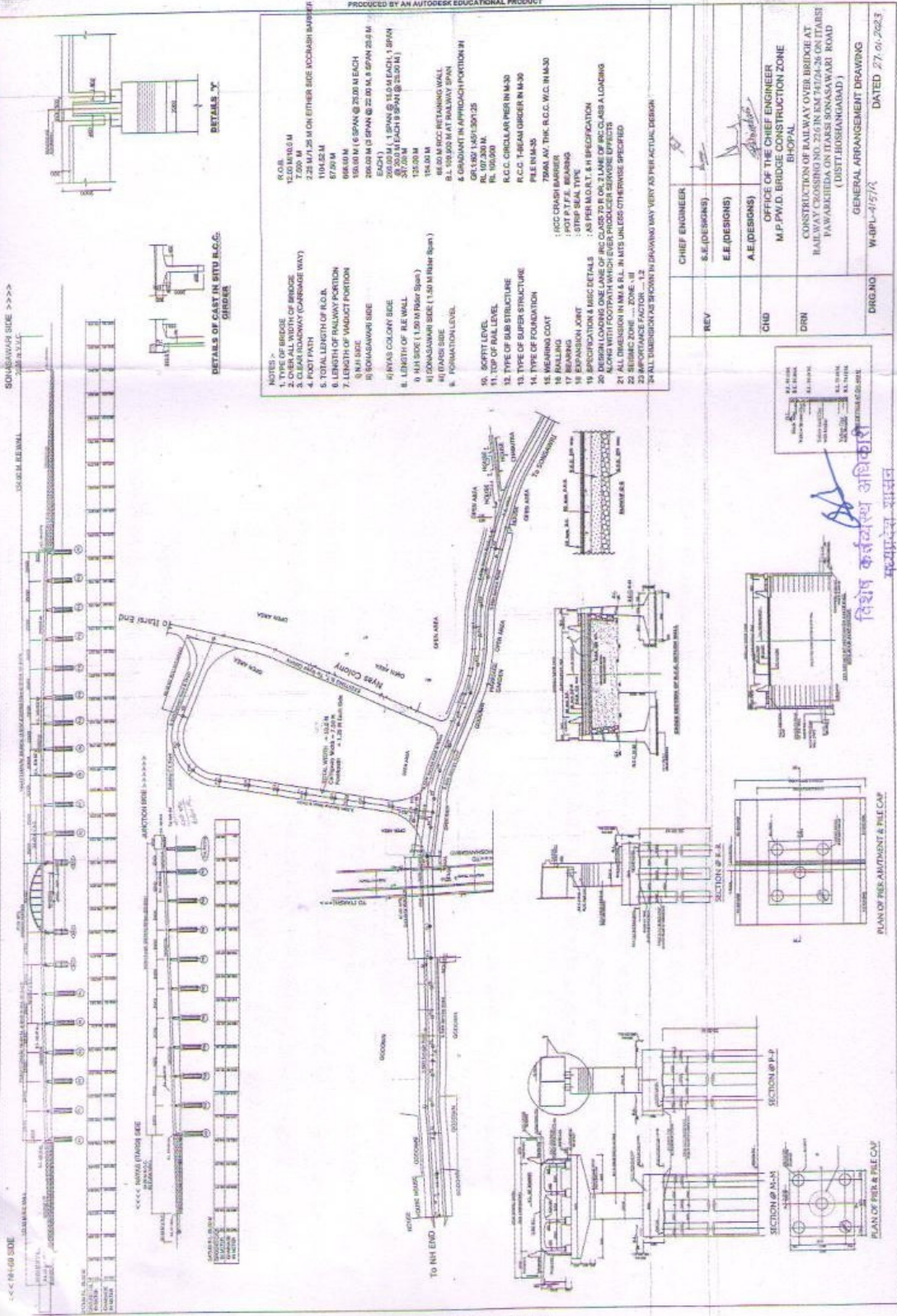

NOTES -

1. BRIDGE
2. OVER ALL WIDTH OF BRIDGE
3. CLEAR ROADWAY (CARRIAGE WAY)
4. FOOT PATH
5. TOTAL LENGTH OF BRIDGE
6. LENGTH OF APPROACH PORTION
7. LENGTH OF MAJOR PORTION
8. R.M. SIDE
9. SONASAWARI SIDE
10. H.M.S. COLONY SIDE
11. LENGTH OF PILE WALL
12. H.M. SLOPE (1:50) (Major Span)
13. SONASAWARI SIDE (1:50) (Minor Span)
14. ROAD SIDE
15. FOUNDATIONAL LEVEL
16. SOFTIT LEVEL
17. TOP OF RAIL LEVEL
18. TYPE OF SUBSTRUCTURE
19. TYPE OF SUPERSTRUCTURE
20. WEARING COAT
21. R.C.C. CHAIR
22. R.C.C. TIE BAR
23. R.C.C. TIE BAR
24. R.C.C. TIE BAR
25. R.C.C. TIE BAR
26. R.C.C. TIE BAR
27. R.C.C. TIE BAR
28. R.C.C. TIE BAR
29. R.C.C. TIE BAR
30. R.C.C. TIE BAR
31. R.C.C. TIE BAR
32. R.C.C. TIE BAR
33. R.C.C. TIE BAR
34. R.C.C. TIE BAR
35. R.C.C. TIE BAR
36. R.C.C. TIE BAR
37. R.C.C. TIE BAR
38. R.C.C. TIE BAR
39. R.C.C. TIE BAR
40. R.C.C. TIE BAR
41. R.C.C. TIE BAR
42. R.C.C. TIE BAR
43. R.C.C. TIE BAR
44. R.C.C. TIE BAR
45. R.C.C. TIE BAR
46. R.C.C. TIE BAR
47. R.C.C. TIE BAR
48. R.C.C. TIE BAR
49. R.C.C. TIE BAR
50. R.C.C. TIE BAR

| | |
|---------|---|
| REV | CHIEF ENGINEER |
| | S.E. (DESIGN) |
| | E.E. (DESIGN) |
| | A.E. (DESIGN) |
| CHKD | OFFICE OF THE CHIEF ENGINEER M.P. P.V.D. BRIDGE CONSTRUCTION ZONE BHOJAL |
| DRN | CONSTRUCTION OF RAILWAY BRIDGE BEFORE AT RAILWAY CROSSING NO. 226 IN RM. 207/208/209/210 PAWARKHEDA ON TRAKES SONASAWARI ROAD (DIST. BHOSHANGABAD) |
| DRG. NO | GENERAL ARRANGEMENT DRAWING |
| | W.A.P.L.-47574 |
| | DATED 27.01.2023 |

विशेष कार्यवाही अधिकारी
समयपूर्वक संपन्न
लोक निर्माण विभाग, भद्रालय